

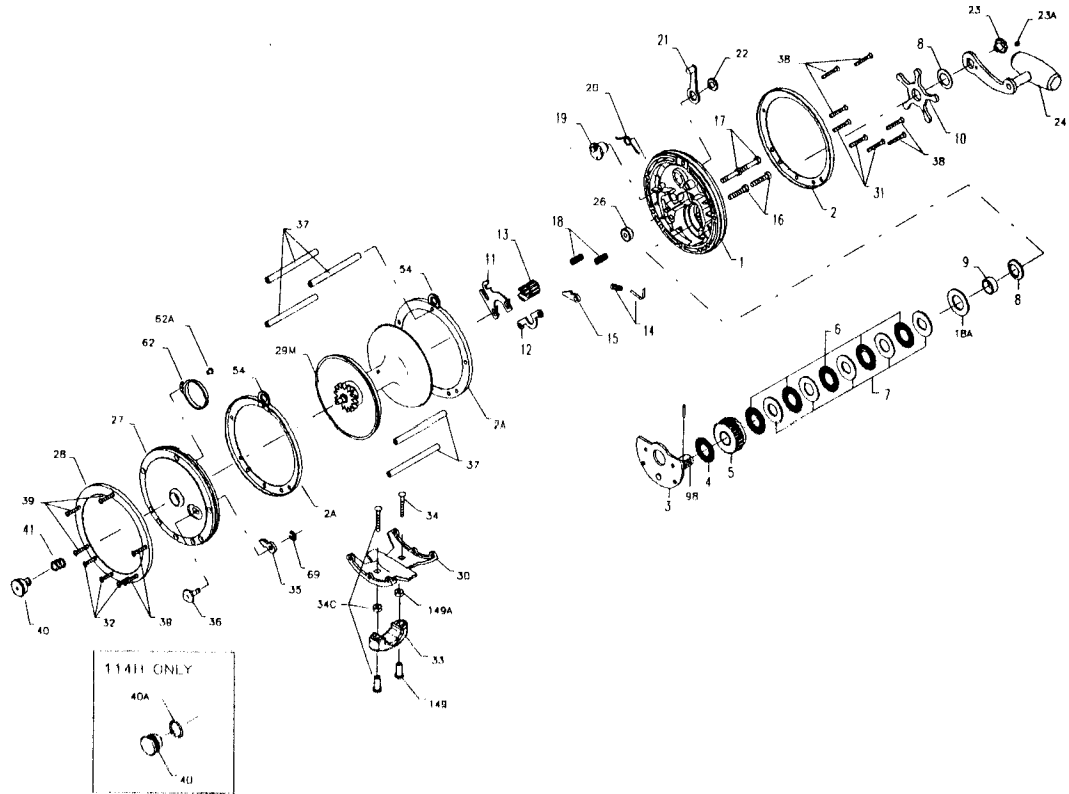

PARTS AND PRICE LIST FOR MODELS 114 AND 114H



KEY No.	PART No.	Description	Price	KEY No.	PART No.	Description	Price
1	001 114	Right Side Plate	\$9.25	23	023 116	Handle Screw	\$3.10
	001 114H	Right Side Plate	10.15	23A	110 060	Handle Lock Screw	.45
2	002 114O	Ring Outer	8.00	24	024 114	Handle (114)	10.75
	002 114O	Right Side Ring Outer (114H)	8.00		024 115	Handle (114H)	11.75
2A	002 114I	Inner Ring	8.00	26	026 114	Bearing Right Side	3.05
3	003 114	Bridge w/Sleeve	10.75		026 116	Bearing Right Side (114H)	12.50
	003 114H	Bridge w/Sleeve	10.75	27	027 114	Left Side Plate	7.50
4	004 114	Fiber Washer (114)	.55		027N114H	Left Side Plate	8.00
	004 115	Fiber Washer (114H)	.80	29L	029L114	Aluminum Spool (114)	50.00
5	005 114	Main Gear (114)	7.50		029L114HL	Aluminum Spool (114H)	50.00
	005 115	Main Gear (114H)	8.30	29M	029M114	Metal Spool (114)	55.00
6	006 114	Drag Washer (114) (5 req.)	1.10		029M114H	Metal Spool (114H)	55.00
	006 115	Drag Washer (114H) (5 req.)	1.25	30	030 114	Stand	11.50
7	007C114	Metal Drag Washer Set (114)	3.50	31	031 011	R.S. Stand Screw (3 req.)	.50
	007C115	Metal Drag Washer Set (114H)	5.00	32	032 020	L.S. Stand Screw (3 req.)	.50
	008 114	Tension Spring	1.10	33	033 340	Rod Clamp	5.50
8A	008 115	Tension Spring	1.10		*033R114	Ringed Rod Clamp (Optional)	9.95
9	009N114	Spacing Sleeve (114)	1.50	34	034 045	Clamp Screw (2 req.)	1.00
	009 114H	Spacing Sleeve (114H)	1.50	34C	034C045	Rod Clamp Screw w/Nuts	2.50
10	010 114	Star Drag Wheel	4.40	35	035 114	Click Tongue	1.25
11	011 114	Eccentric Jack	2.65	36	036 114H	Click Button	1.50
12	012 114	Pinion Yoke	1.80	37	037 114	Frame Post (5 req.)	2.20
13	013 114	Pinion (114)	5.10	38	039 013	R.S. Post Screw (5 req.)	.50
	013 114H	Pinion (114H)	5.25	39	039 012	L.S. Post Screw (5 req.)	.50
14	014 114	Dog Spring	.40	40	040 114	L.S. Bearing (114)	3.50
15	015 114	Dog (114)	1.10		**040 114HL	L.S. Bearing (114H)	12.95
	015 114H	Dog (114H)	1.10	40A	120 114H	L.S. Bearing O-Ring (114H)	.50
16	016 114	Bridge Screw Lower (2 req.)	.55	41	041 114	L.S. Bearing Spring (114)	1.05
17	017 114	Bridge Screw Upper (2 req.)	.55	54	054 114	Harness Lug (2 req.)	1.75
18	018 114	Clutch Spring	.50	62	062 114	Click Spring	1.60
18A	018 114H	Spring Disc (114H)	1.00	62A	063 209	Click Spring Screw	.50
19	019 114	Eccentric	2.80	69	069B600	Retaining Ring	.90
20	020 114	Eccentric Spring	.85	98	098 114	Gear Sleeve	5.00
21	021 114	Eccentric Lever	2.25	149	149 045	Clamp Nut (2 req.)	1.00
22	023 060	Eccentric Screw	1.75	149A	149 200	Hex Nut (2 req.)	.50

*Not Shown

**Owners of Older 114H reels must order 40-114H